

Category:	Non-Capacity Solenoid Pump
Application:	Water Series
Classification:	Pressure (Piston) Type

FEATURES:

- This model was made for Food / Sanitation application in water series, pressure (piston) type.
- The each material of the parts is corresponding to the standard of U.S. Food and Drug Administration.

PRIMARY APPLICATIONS:

- Used to transfer food & sanitation water based liquids under pressure. (Coffee machine)

**SPECIFICATIONS:**

MODELS	VW125F
SPECIFICATIONS	
Power Sources	100 - 240VAC (50 or 60Hz) [Half-Wave Rectifier is Required]
Power Consumption	34W (TyP.) / 50W (Max)
Maximum Free Flow Rate	20L/H (TyP.)
Maximum Pressure (No Flow)	10 Bar (TyP.)
Suction Level	-0.5m ~ 0m
Fluid	Drinking Water
Operating Temperature	-20 ° C ~ 40 ° C (Non-Freezing)
Mounting Thread	2x 6mm drilling
Piping Connection Sizes	Intake : tbd Outlet : tbd
Weight	0.65 kg

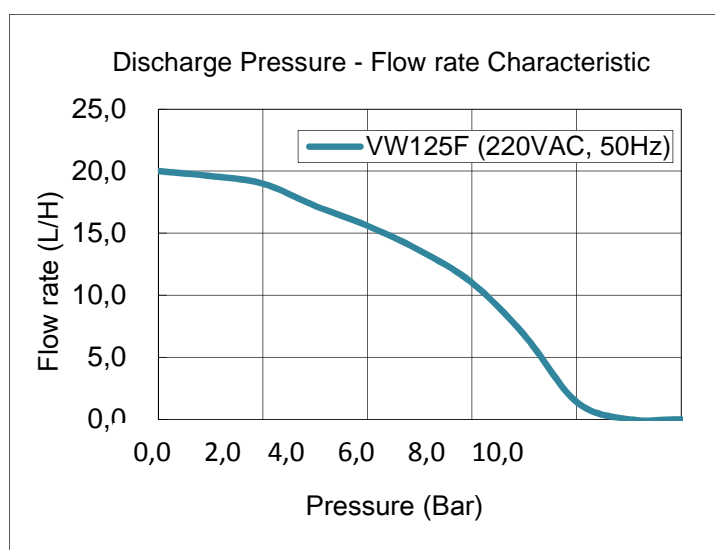
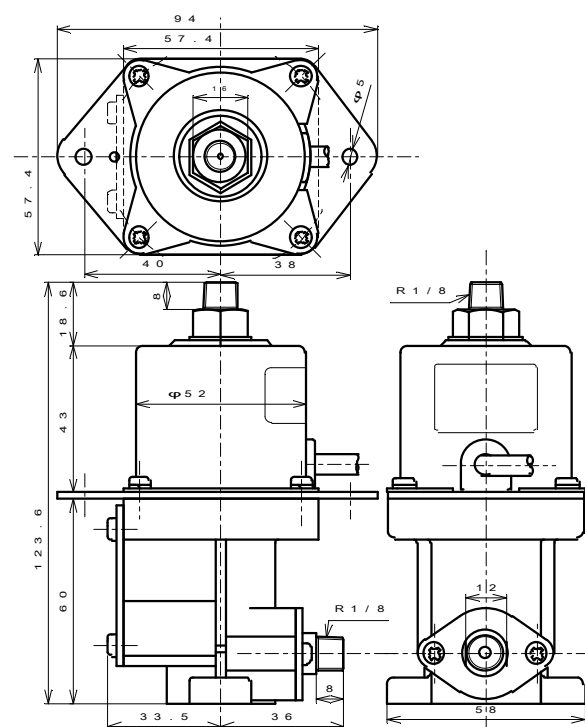
OUTLINE DRAWING:

The graph is a central value and not a guaranteed value.