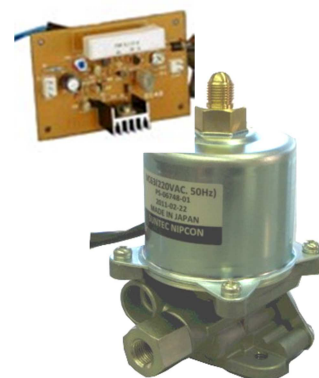

Category:	Non-Capacity Type Solenoid Pump
Application:	Oil Series
Classification:	Pressure (Piston) Type

FEATURES:

- These non-capacity solenoid pump models are linearly controlled by pulse with modulation (PWM) in variable pressure oil applications.
- Every pump models in this series can be adapted at the factory input use with one of different input voltages. For the AC input voltage options, usually the pump output pressure is generated when a half-wave AC voltage is applied.

**PRIMARY APPLICATIONS:**

- Used as a precision (PWM controlled) "gun-type" burner in kerosene space heaters and light oil water boilers.
- Used as a pressure type actuator.

SPECIFICATIONS:

MODELS	VC63
SPECIFICATIONS	
Power Sources	100 - 240VAC [Pulse Width Modulation Circuit Board is Required] 12 - 24VAC [Pulse Width Modulation Circuit Board is Required]
Power Consumption	19W (Typ.) / 45W (Max)
Maximum Free Flow Rate	10L/H (TyP.)
Maximum Pressure (No Flow)*	18 Bar (TyP.)
Pressure Regulation System	Without a mechanical pressure regulation system
Corresponding Nozzle	1.0GPH ~ 1.5GPH
Suction Level(m)	-1m ~ +2m
Internal Solenoid Cut-off Valve	Yes
Operating Temperature	-20 ° C ~ 40 ° C (Non-Freezing)
Mounting Thread	2x M6*1
Piping Connection Sizes	Intake : R 1/8" B male, R 1/8 female, G 1/8 male Outlet : G 1/8" B (Half Spherical Surface of Radius 4 mm),
Weight	0.72 kg

* Measurements of the maximum flow rate and the maximum pressure are dependent upon the type of nozzle used conjunction with each pump. The values given above for VC63 pump models is derived from calculations using 0.4 gal / h and 0.85 gal / h nozzles, respectively.

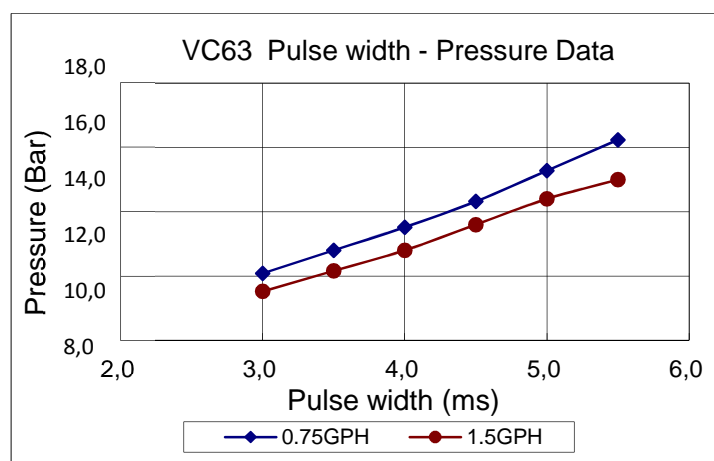
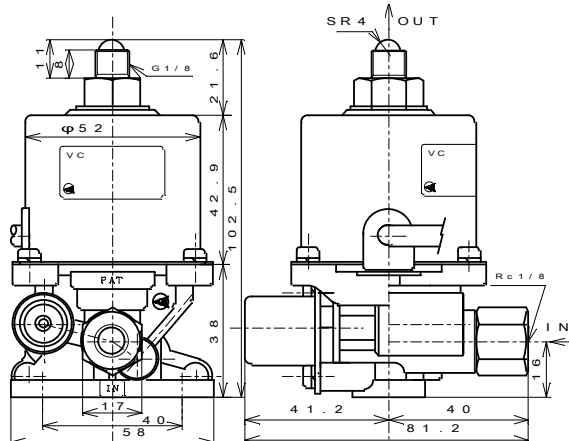
OUTLINE DRAWING:

The graph is a central value and not a guaranteed value.